

NON-CONTACT VOLTAGE DETECTOR MODEL - 273 HP

The 273 HP is a Non-contact voltage detector. It has two ranges for selection. The 273 HP consists of an internal pickup sensor, a function selection switch, a visual and a sound annunciator. With the 273 HP, physical contact with electrical conductors is not necessary when testing for live lines.

Its sensor senses the radiated field which surrounds live conductors. Radiated field strength increases with voltage and decreases quickly with distance or earth shielding.

Some of the typical applications are : non-contact detection of live voltages; find faults in cables; check & detect live high voltage cables; trace live wires; check high frequency radiation; check grounding equipment ; detect residual or induced voltages.

- 2 ranges for selection : LOW 50V~1.5kV HIGH 1.5kV~132kV
- There is no power consumption in off mode : 0 μ A
- Nice mechanical slide switch for function selection : HIGH / OFF / LOW
- The power consumption in low voltage detection mode : Less than 20mA
- The power consumption in high voltage detection mode : Less than 20mA
- Bright LED and audible alarm sound when voltage is present.
- Lightweight, robust and compact.
- Efficient and easy to use
- Users have to use the Hot Stick when test high voltages between 1.5kV~132kV.
- SEW provides nice optional accessories of Hot Sticks HS-175 and HS-120 for high voltage detection.
- Optional accessories : HS-175 Telescopic hot stick (triangle-type), HS-120 Hot stick

SPECIFICATIONS

- **Operating temperature** : 0°C~40°C
- **Power supply** : 9V(6F22) x 1
- **Accessories** : User manual, Battery, Carry case
- **Dimensions** : 245(L) x 80(W) x 37(D)mm
- **Weight** : Approx. 175g (battery included)
- **Safety** : EN 61326-1; EN 61000-4-2 EN 61000-4-3

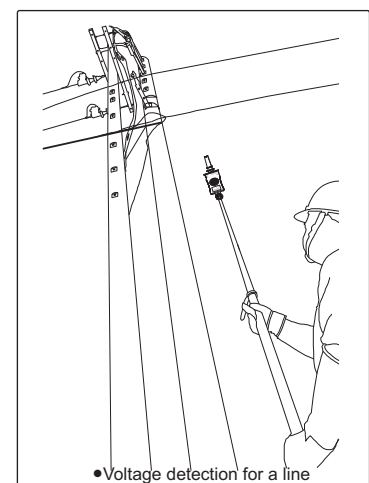
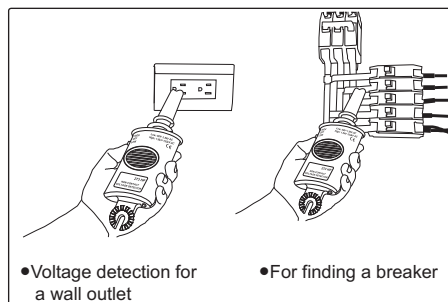
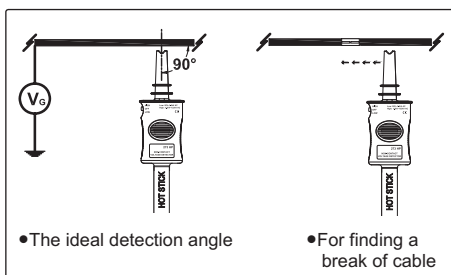

All Specifications are subject to change without prior notice



WARRANTY

Each "KUSAM-MECO" product is warranted to be free from defects in material and workmanship under normal use & service. The warranty period is one year (12 months) and begins from the date of despatch of goods. In case any defect occurs in functioning of the instrument, under proper use, within the guarantee period, the same will be rectified by us free of charges, provided the to and fro freight charges are borne by you. This warranty extends only to the original buyer or end-user customer of a "KUSAM-MECO" authorized dealer. This warranty does not apply for damaged IC's, fuses, disposable batteries, carrying case, test leads, or to any product which in "KUSAM-MECO's" opinion, has been misused, altered, neglected, contaminated or damaged by accident or abnormal conditions of operation or handling. "KUSAM-MECO" authorized dealer shall extend this warranty on new and unused products to end-user customers only but have no authority to extend a greater or different warranty on behalf of "KUSAM-MECO". "KUSAM-MECO's" warranty obligation is limited, at option, free of charge repair, or replacement of a defective product which is returned to a "KUSAM-MECO" authorized service center within the warranty period. THIS WARRANTY IS BUYER'S SOLE AND EXCLUSIVE REMEDY AND IS IN LIEU OF ALL OTHER WARRANTIES, EXPRESS OR IMPLIED, INCLUDING BUT NOT LIMITED TO ANY IMPLIED WARRANTY OF MERCHANTABILITY OR FITNESS FOR A PARTICULAR PURPOSE. "KUSAM-MECO" SHALL NOT BE LIABLE FOR ANY SPECIAL, INDIRECT, INCIDENTAL OR CONSEQUENTIAL DAMAGES OR LOSSES, INCLUDING LOSS OF DATA, ARISING FROM ANY CAUSE WHATSOEVER. All transactions are subject to Mumbai Jurisdiction.



An ISO 9001:2015 Company

17, Bharat Industrial Estate, T. J. Road, Sewree (W), Mumbai-400015. INDIA

Sales Direct: 24156638

Tel.:(022)2412 4540, 2418 1649

Fax:(022)2414 9659

E-mail : kusam_meco@vsnl.net,



An ISO 9001:2015 Company

NON-CONTACT VOLTAGE DETECTOR



Model : 273HP

INSTRUCTION MANUAL

INDEX	Page
1. INTRODUCTION.....	1
2. SAFETY PRECAUTION.....	2-3
3. APPLICATIONS.....	3
4. FEATURES & SPECIFICATIONS.....	4
5. INSTRUMENT LAYOUT.....	5
6. OPERATION.....	6-8
7. MAINTENANCE.....	9

7. MAINTENANCE

- Battery replacement
 - (1) Unscrew the battery cover on the rear with a screwdriver, then slide the battery cover off the tester.
 - (2) Take out the battery.
 - (3) Replace with a new battery (Alkaline battery 9V).
 - (4) Reinstall the battery cover and fasten the cover screws.

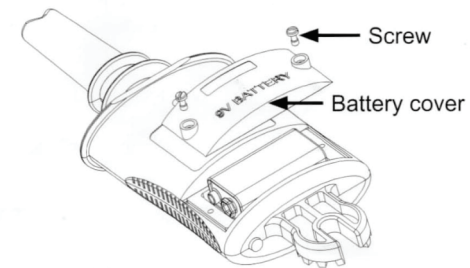

- Cleaning and Storage :

⚠ WARNING

To avoid electrical shock or damage to the meter, do not get water inside the case.

- (1) Periodically wipe the case with a damp cloth and detergent; do not use abrasives or solvents.
- (2) If the detector is not used for periods of longer than 60 days, remove the battery and store them separately.

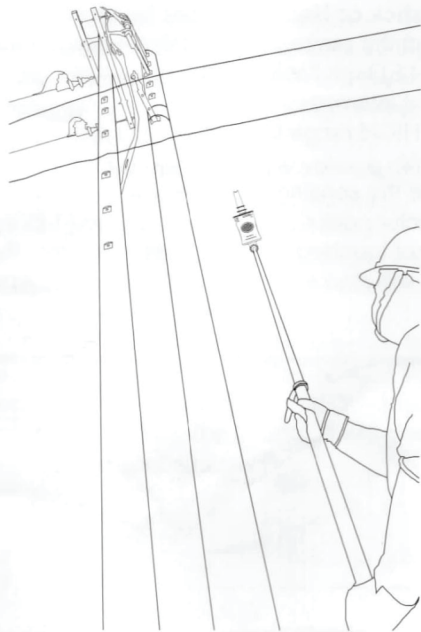

Voltage detection for a line

1. INTRODUCTION

NOTE

This detector has been designed and tested according to CE Safety Requirements for Electronic Measuring Apparatus. Follow all warnings to ensure safe operation.

WARNING

**READ "SAFETY PRECAUTION" (NEXT PAGE)
BEFORE USING THE NON-CONTACT VOLTAGE
DETECTOR.**

2. SAFETY PRECAUTION

Electricity can cause severe injuries with high voltages. Therefore it is very important to read the following info before using the Non-contact Voltage Detector.

This must only be used and operated by a competent trained person and in strict accordance with the instructions. We will not accept liability for any damage or injury caused by misuse or non compliance with instructions and safety procedures.

Examine the Non-contact Voltage Detector to make sure it is clean and dry. If it is not, wipe with a clean, dry, lint-free cloth.

The Non-contact Voltage Detector test should always be used as an indication only.

Read all safety information carefully before attempting to operate or service the Non-contact Voltage Detector.

Use the Non-contact Voltage Detector only as specified in this manual. Otherwise, the protection provided by the Non-contact Voltage Detector may be impaired.

Please keep in your mind to wear high insulated gloves when you test high voltages between 600V~1.5kV.

- **HIGH range (High voltage detection, Telescopic hot stick or Hot stick must be attached)**

Select the range of HIGH (High voltage range), the blue LED will flash and the buzzer will generate a sound intermittently.

The HIGH range for high voltage detection 1.5kV~132kV.

Place the sensing tip of the Non-contact Voltage Detector near a high voltage source (1.5kV~132kV), but not touching the high voltage source, the blue LED will glow and the sound will last continuously.

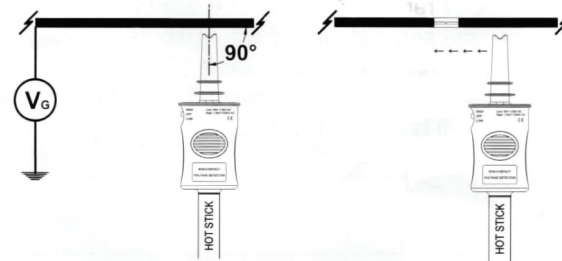

The ideal detection angle

Finding a break of cable

6. OPERATION

- **Power and range selection switch**

When users turn on the Non-contact Voltage Detector, the blue LED will flash and the buzzer will generate a sound intermittently, Select "HIGH" range for high voltage detection, "LOW" range for low voltage detection.

- **LOW range (Low voltage detection)**

Select the range of LOW (Low voltage range), the blue LED will flash and the buzzer will generate a sound intermittently.

The LOW range for low voltage detection 50V~1.5kV
Place the sensing tip of the Non-contact Voltage Detector near a low voltage line (50V~1.5kV), but not touching the line, the blue LED will glow and the sound will last continuously.

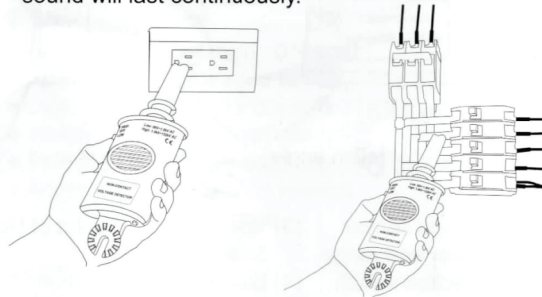

Voltage detection
for a wall outlet

Finding a breaker

Please keep in your mind to wear high insulated gloves and to use the hot stick or telescopic hot stick when you test high voltages between 1.5kV~132kV.

3. APPLICATIONS

- Non-contact detection of live voltages
- Find faults in cables
- Check and detect live high voltage cables
- Trace live wires
- Check high frequency radiation
- Check grounding equipment
- Detect residual or induced voltages

4. FEATURES & SPECIFICATIONS

- Power and range selection switch
3 positions: HIGH / OFF / LOW
- 2 ranges for selection
Low : 50V~1.5kV
Select the range of LOW (Low voltage range),
the Non-contact Voltage Detector is ready for
low voltage detection.
HIGH :1.5kV~132kV
Select the range of HIGH (High voltage range)
, the Non-contact Voltage Detector is ready
for high voltage detection.
- Power consumption :
OFF : 0uA
Low voltage detection mode: Less than 20mA
High voltage detection mode : Less than 20mA
- Duty cycle : Continuous
- Response time : Instantaneous
- Operating temperature : 0°~50°C
- Power source : **Alkaline battery** 9V x 1
- Dimensions : 245(L) x 80(W) x 37(D) mm
- Weight : Approx. 175g (Battery included)
- Safety standard : EN 61326-1
- Accessories : Instruction manual
Carry case
Battery
- Optional accessory:
Telescopic hot stick
Hot stick

5. INSTRUMENT LAYOUT

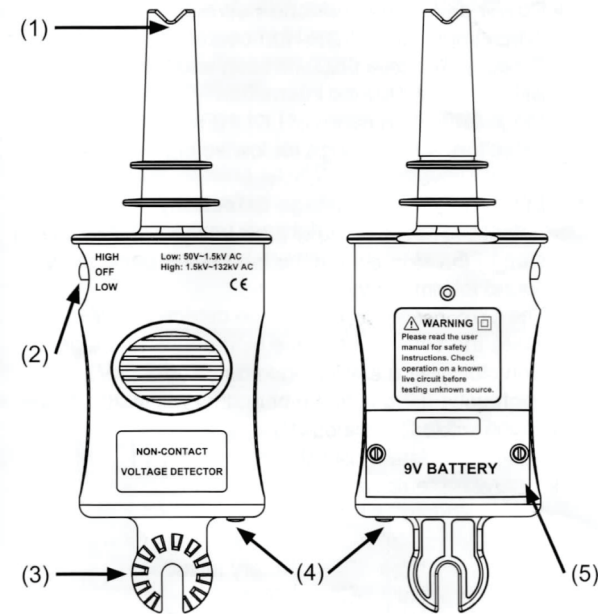

- | | |
|--------------------------------------|---------------------------------------|
| (1) Voltage sensor | (3) The connection point of Hot Stick |
| (2) Power and range selection switch | (4) Blue LED for indication |
| | (5) Battery cover |